

Saltire Village Heritage Walk



An ideal family walk through the streets of Titus Salt's Model Village. The walk is suitable for most reasonably fit and occasional walkers and can be accessed by wheelchair users.

Saltire is named after Titus Salt and the River Aire, which runs through the village. Titus Salt rose from modest beginnings to become one of the country's most successful industrialists. He was deeply religious and a firm believer in the benefits of education. Salt had the village built so that he could make fine wool fabrics using the most efficient methods available and provide a healthy environment for his workers. Henry Lockwood and William Mawson were the young architects employed to realise this vision. Saltire took twenty-five years to complete and began with the building of the Mill in 1851.

It is not just the people who have lived in Saltire that have benefited from Salt's carefully planned 'model' village. This tour highlights how many of our towns in the United Kingdom, and even overseas, have been influenced by ideas first brought together successfully in Saltire.

Our tour begins on the bridge over the railway line. Look down Victoria Road towards the countryside beyond the village. Salt's most influential idea was to relocate his entire business to a greenfield site in order to escape the chaos of Bradford, where he had started his first factories. It was the country's fastest growing town; the population had exploded from 13,000 in 1801 to 104,000 in 1851. Bradford was a crowded and unhealthy place to live with limited space for a factory on the scale Salt envisaged. Many industrialists followed Salt's example and built factory towns of their own such as Bournville (George Cadbury) and Port Sunlight (W H Lever).

Continue downhill along Victoria Road, passing the impressive church on the left until you reach the canal bridge. Despite its rural location Saltire was not isolated. Salt thought like any modern business person. He wanted to distribute his products quickly and cheaply so he chose a site with excellent transport links. The Mill was built beside the railway, the motorway of the nineteenth century. The canal linked the village to Leeds and Liverpool and there were good local road connections.



The former Congregational Church was provided for the spiritual welfare of Salt's employees. Its magnificent interior should not be missed.

Turn left down the ramp and follow the path around to the right to cross the River Aire by the modern footbridge. Salt believed leisure was good for his workers' health, particularly as a distraction from the temptations of alcohol. Public houses were not permitted in the village. A park was included in Salt's plans from an early stage. It was completed in 1871. You can extend your tour by taking a walk around it. In Britain the public town park first appeared in the 1830s. They quickly became a symbol of civic pride and prosperity.

Retrace your steps back to the railway bridge and look towards the mill chimney. Can you feel a breeze behind you? Salt was concerned about the harmful effects of smoke produced by factories and so located his mill where the prevailing westerly winds would blow the smoke away from the village. The Mill is clearly separated from the housing by the allotments where workers could grow their own food, another healthy distraction from the temptations of drink! This zoning approach was copied at other company towns and is echoed today by concentrating noisy and dirty businesses in industrial estates.



Salt's Mill housed a complete multi-stage manufacturing process transforming raw llama and alpaca wool into finished luxury cloth.

Turn around and walk down the cobbled Albert Terrace. Then turn left into William Henry Street. As you walk along notice the different types of houses around you, they reflect the status of their nineteenth century tenants. The three storey houses originally provided shared lodgings for single workers. Small front gardens and more spacious houses were provided for the 'overlookers', the foremen of the factory floor. Turn right onto Caroline Street. Here the front doors of the properties open straight onto the street indicating that they were for lower paid employees.

As you walk along you will see the streets branch off at regular intervals. This grid pattern was chosen to use the available land efficiently. Although the houses are close together, Lockwood and Mawson ensured that their height in relation to the width of the road allowed each house to receive ample daylight. A well thought-out layout is the basis for any town plan to ensure land is not wasted.

Continue to the junction with Albert Road. Here turn left uphill. First you will pass a row of 'overlookers' houses before finding the grandest semi-detached residences, home to the company's executives, teachers and the church minister. Originally they had fine views over open country.

At the top of Albert Road, turn left and use the zebra crossing to cross Saltire Road. Continue straight ahead and then walk left around the corner to reach Bingley Road. Stop here to browse or for a break if you wish before continuing.

At the top of George Street you can see how Lockwood and Mawson have used the natural slope of the land to their advantage to create a dramatic view of the church against the backdrop of the hillside.



All houses were owned by the company. Regardless of the tenant's status each had running water, an outside toilet, gas lights and paved yards, making them exceptional for the period.

Continue along Bingley Road and then turn left into Victoria Road. Grouped around Alexandra Square are the Almshouses. This pleasant green is one of several open areas located at regular intervals along Victoria Road. Spaces like these were normally found only in the most affluent areas of Victorian towns. More ambitious open spaces and gardens became a feature of company towns, housing estates and suburbs designed after Saltire.



Forty years before the first state pension, elderly or infirm persons of good 'moral character' were provided with a home and a pension in the Almshouses.

Continue downhill until you reach the crossroads, where the former Hospital building stands at the corner. Use the puffin crossing to continue along Victoria Road. You will soon reach two of the finest buildings in the village, the School on the left and the Institute on the right. They are set back from Victoria Road with an open space in front to form Victoria Square. Named in honour after the Queen, Victoria Road linked all the community facilities and important buildings together, creating another distinct zone within the village.



Victorian mills depended on child labour, but their hours were controlled by law to ensure they attended school regularly. Many mill owners provided school rooms but Salt's fine building was exceptional.



Opportunities for adult learning and socialising were provided in the Institute. Facilities included a lecture hall, library, gymnasium and games room.

Continue along Victoria Road past the row of shops to complete your tour where it began at the railway bridge.

In designing and building Saltire, Titus Salt and his architects demonstrated that planning a town was preferable to allowing them to grow haphazardly. Salt's example was followed by other industrialists and gradually the campaign for town planning gained momentum. More than fifty years after Saltire was begun, national and local governments accepted that the social problems created by the rapid expansion of industrial towns were their duty to tackle. With the 1909 Housing and Town Planning Act the foundations of the modern planning system were laid. Today this governs how all land is used wherever we live in the United Kingdom.

Saltire welcomes visitors, it is, however, a working, living village. Please respect the privacy of residents.

For detailed information on travel, opening times of attractions, ideas on things to do in Saltire and the surrounding area, contact:

VISIT BRADFORD BRITANNIA HOUSE 12 BROADWAY BRADFORD BD1 1JF

Telephone: 01274 433678 www.visitsaltire.com

SHIPLEY GLEN TRAMWAY



Shipley Glen Tramway is 111 years old and is Britain's oldest working cable hauled tramway. It is still driven by some of the original machinery. The tramway is a nostalgic ride through woodland with two toastrack trams which run weekend afternoons and Bank Holidays all year (Sundays only in Nov, Jan and Feb).

Visit the website www.glentramway.co.uk or telephone 01274 589010 for more information on the tramway and for details of special events.

THE AIRE SCULPTURE TRAIL

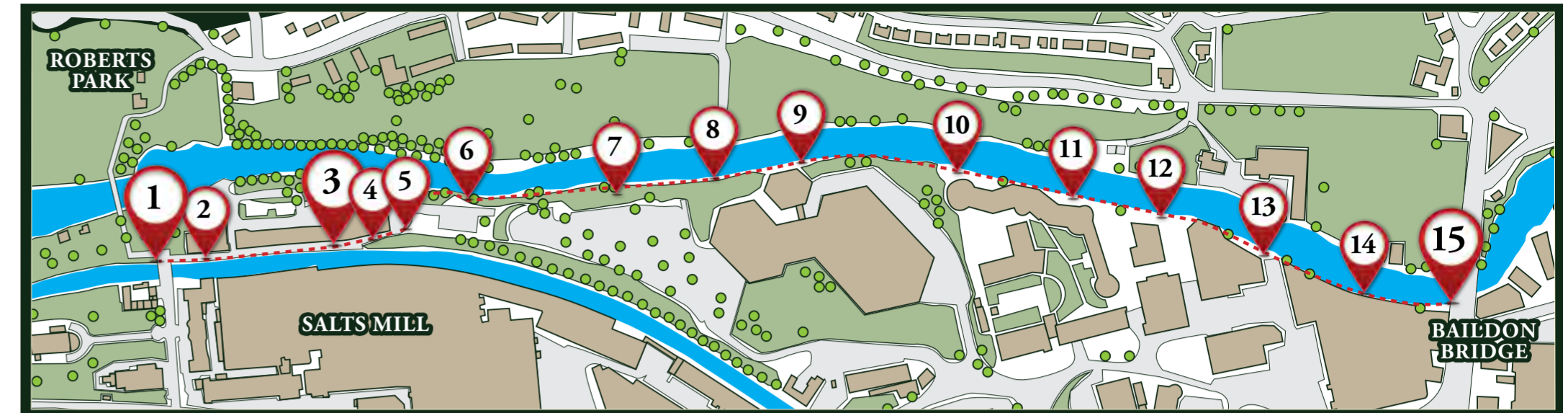

This trail, which starts from the bridge on Victoria Road, is an integral part of improving the use of the footpath alongside the River Aire between Baildon Bridge and Saltire.

KEY				
1 Octopus	4 Tortoises	7 Cat bath	10 Snowman	13 Submarine
2 Pirate ship	5 Fish & drawers	8 Bird	11 Dog	14 Frog on leaf
3 Salt pot slug	6 Fish	9 Skater frog	12 Alpaca	15 Dinghy dog

This exciting development has been created for the benefit of residents and visitors to Saltire and Shipley, it adds a visitor attraction to the area and encourages the use of this footpath link

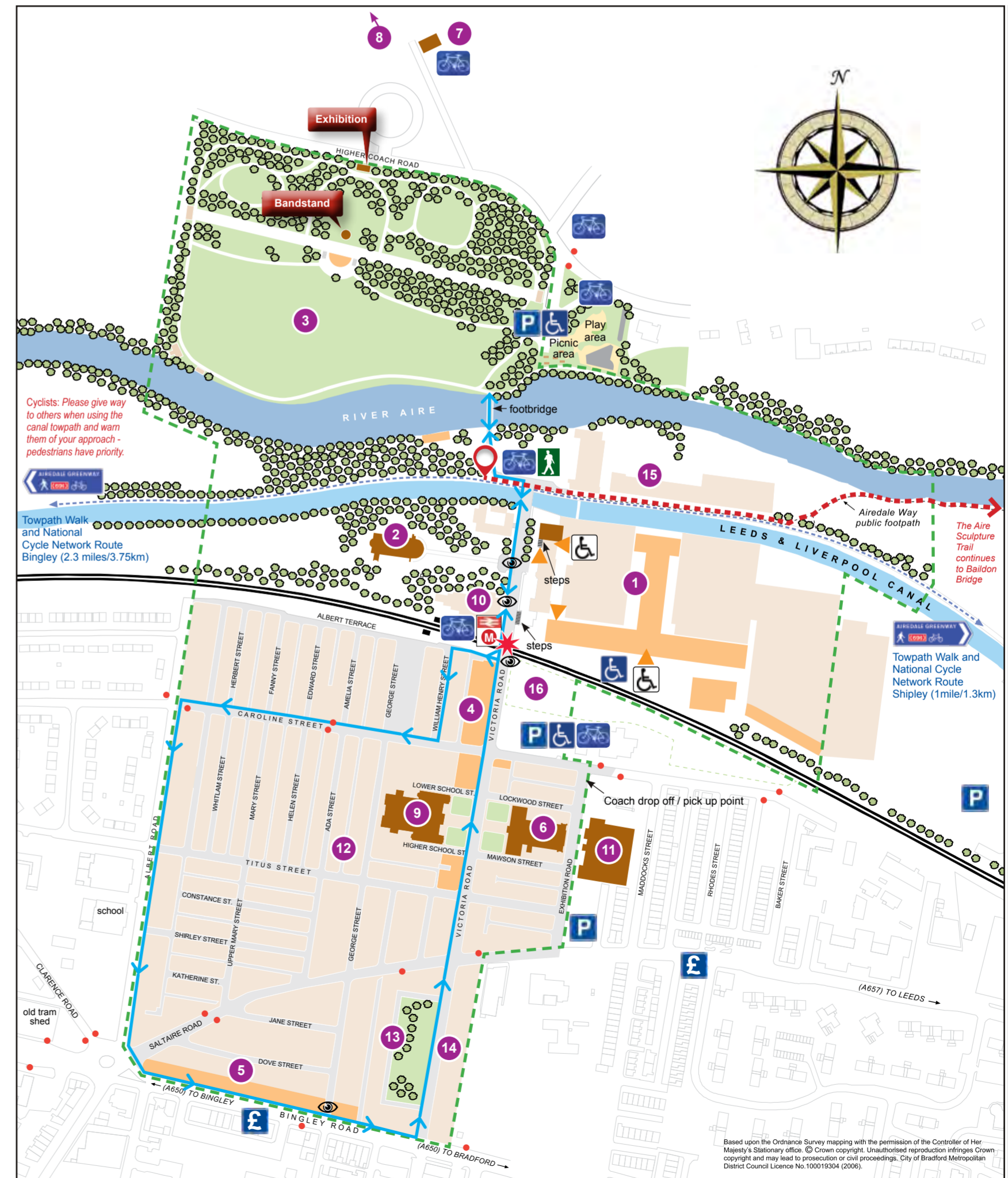

Key	
	Heritage Walk Route
	Start of Countryside Walks
	Start of The Aire Sculpture Trail
	Viewpoint
	Start of World Heritage Site Walk
	Shops / cafes / restaurants / bars
	Public entrance
	Public disabled entrance
	Parking
	Disabled Parking
	Cycle parking stands
	Railway station
	Cash machine
	World Heritage Site boundary

Places of interest within the World Heritage Site open to visitors	
1	Salts Mill and 1853 Gallery
2	Saltire United Reformed Church
3	Roberts Park
4	Victoria Road retail area
5	Gordon Terrace retail area
6	Victoria Hall

Places of interest near to Saltire open to visitors	
7	Shipley Glen Tramway and Museum
8	Shipley Glen

Other places of interest not open to visitors	
9	Shipley College Salt Building
10	Dining Room
11	Shipley College Exhibition Building
12	Housing
13	Almshouses
14	Hospital
15	New Mill
16	Allotment Gardens

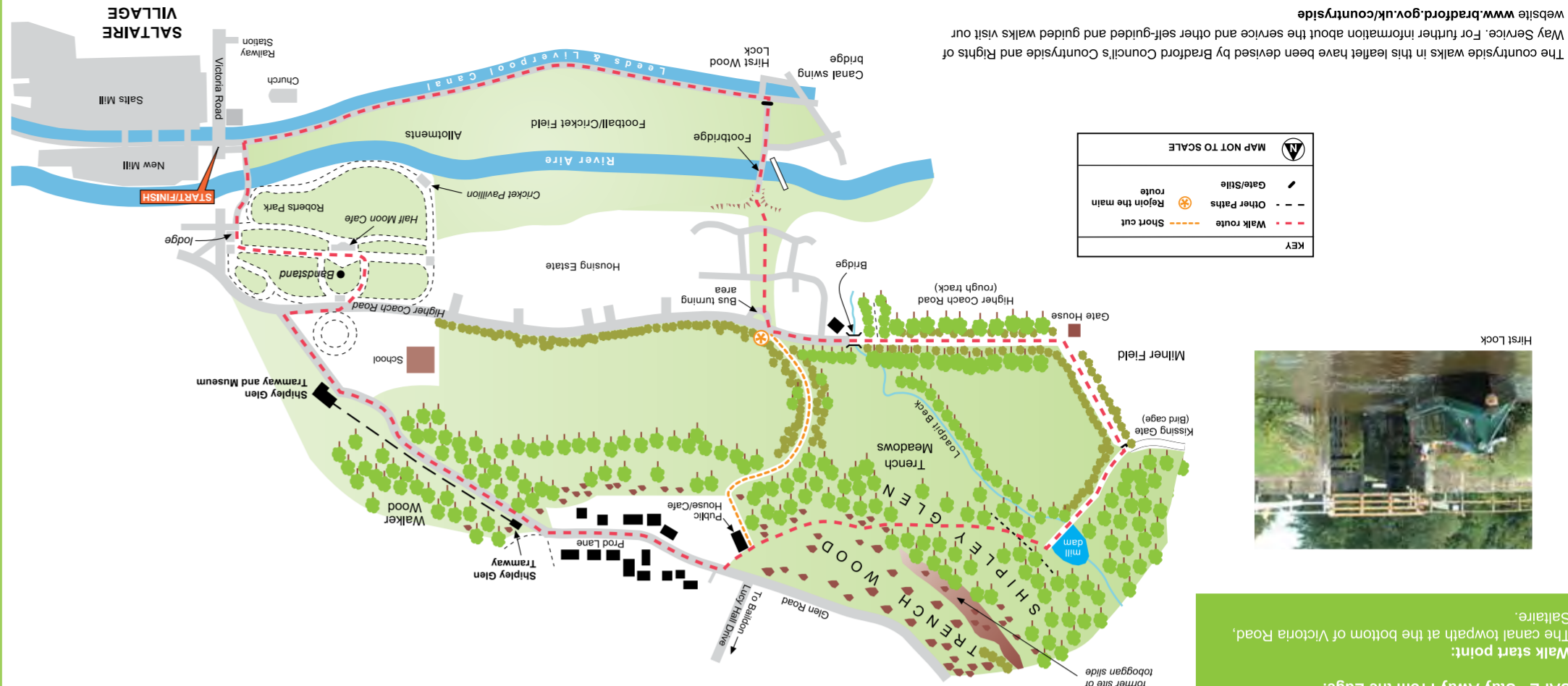

Walk start point: The canal towpath at the bottom of Victoria Road, Saltaire.
Walk start point: SAFE - Stay Away From the Edge.
 Please take care whilst walking along the canal towpath and river, especially with children - Be SAFE - Stay Away From the Edge.
 Also advisable.
 At the tramway entrance, follow the path uphill through the trees of Walker Wood. (Alternatively, if the Shipley Glen Tramway is open, why not follow the hedge-lined track downhill to the junction with a rough road at the bottom (Higher Coach Road). Turn left and follow the road continuing straight ahead

The Route

On reaching a rather elaborate metal kissing gate on the canal towpath at Hirst Wood lock. Turn left along the main road on the far side to follow the mill dam. Here, turn left to walk across the front of the mill dam and continue down a short distance further to the left (known locally as 'the bridge'), go through and over the bottom of the hill in the woodland cross over to Trench Wood.
 After a short distance the track coming down from the bus turning area and walk between the houses by a short distance the track down to eventually eventually crossing a small bridge as the rough surface changes to tarmac.
 To continue your walk, go along Prod Lane to eventually turn left and walk behind The Glen Public House & Café. Here, you can if you wish shorten the walk by turning sharp left to go down the well-worn path between River Aire into Roberts Park.
 Once in the park, continue straight ahead and turn left after the park lodge to walk down the promenade. Follow the path to the right after passing the bandstand to exit the park through the gate to the left of the shelter. Leave the park and cross the road, turn right to walk down Higher Coach Road. After the car park turn left into the lane heading for the wooden building ahead (Shipley Glen Tramway).
 At the tramway entrance, follow the path uphill through the trees of Walker Wood. (Alternatively, if the Shipley Glen Tramway is open, why not follow the hedge-lined track downhill to the junction with a rough road at the bottom (Higher Coach Road). Turn left and follow the road continuing straight ahead

Bus and train services to Saltaire

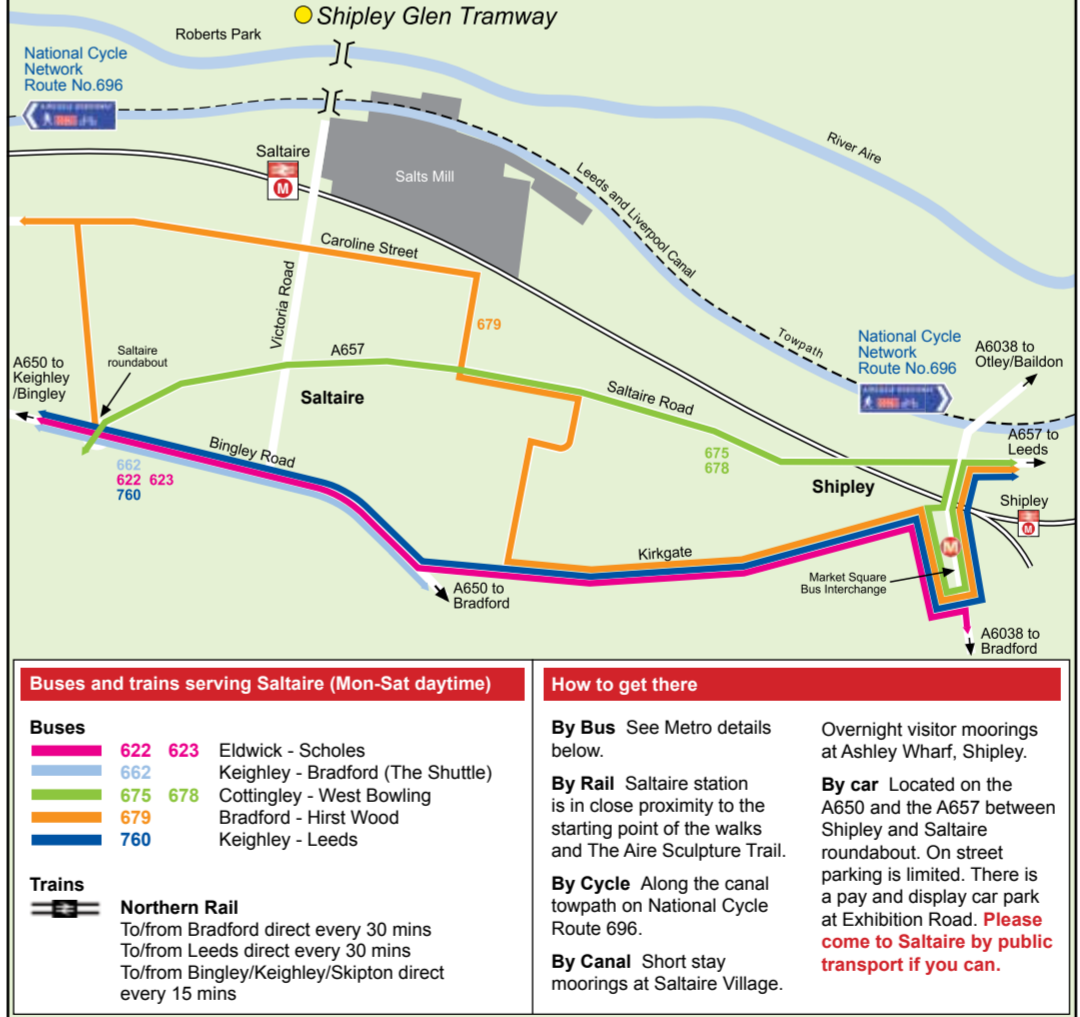

How to get there

By Bus See Metro details below.
By Rail Saltaire station is in close proximity to the starting point of the walks and the Aire Sculpture Trail.
By Cycle Along the canal towpath on National Cycle Route 696.
By Canal Short stay moorings at Saltaire Village.

Overnight visitor moorings at Ashley Wharf, Shipley.
 Located on the A650 and the A657 between Shipley and Saltaire roundabout. On street parking is limited. There is a pay and display car park at Exhibition Road. **Please come to Saltaire by public transport if you can.**

For bus and train services in West Yorkshire

- Visit www.wymetro.com to download timetables, to plan a journey using the Yorkshire Journey Planner and travel ticket details.
- Call MetroLine.com on 0113 245 7676, open 0700 to 2200 daily (except Christmas Day, Boxing Day & New Year's Day).
- Get real-time information on the move with Metro's **youxmetbus** or National Rail's **TrainTracker** real-time systems.
- Call at a staffed bus station travel centre or rail station to discuss your travel needs.
- A West Yorkshire DayRover is a one-day leisure ticket for families and groups.

City of Bradford MDC
www.bradford.gov.uk

As a World Heritage Site it is important that we do what we can to preserve the beauty of Saltaire wherever possible. It is therefore critical that tourism is developed in a sustainable manner. Please consider using public transport when visiting Saltaire as this has much less impact on the unique local environment and on local residents than car based journeys. However, if you choose to travel to Saltaire please have an enjoyable visit.

The wording in this leaflet can be made available in other formats such as large print on request. Please call 01274 434983



Easily accessible by public transport

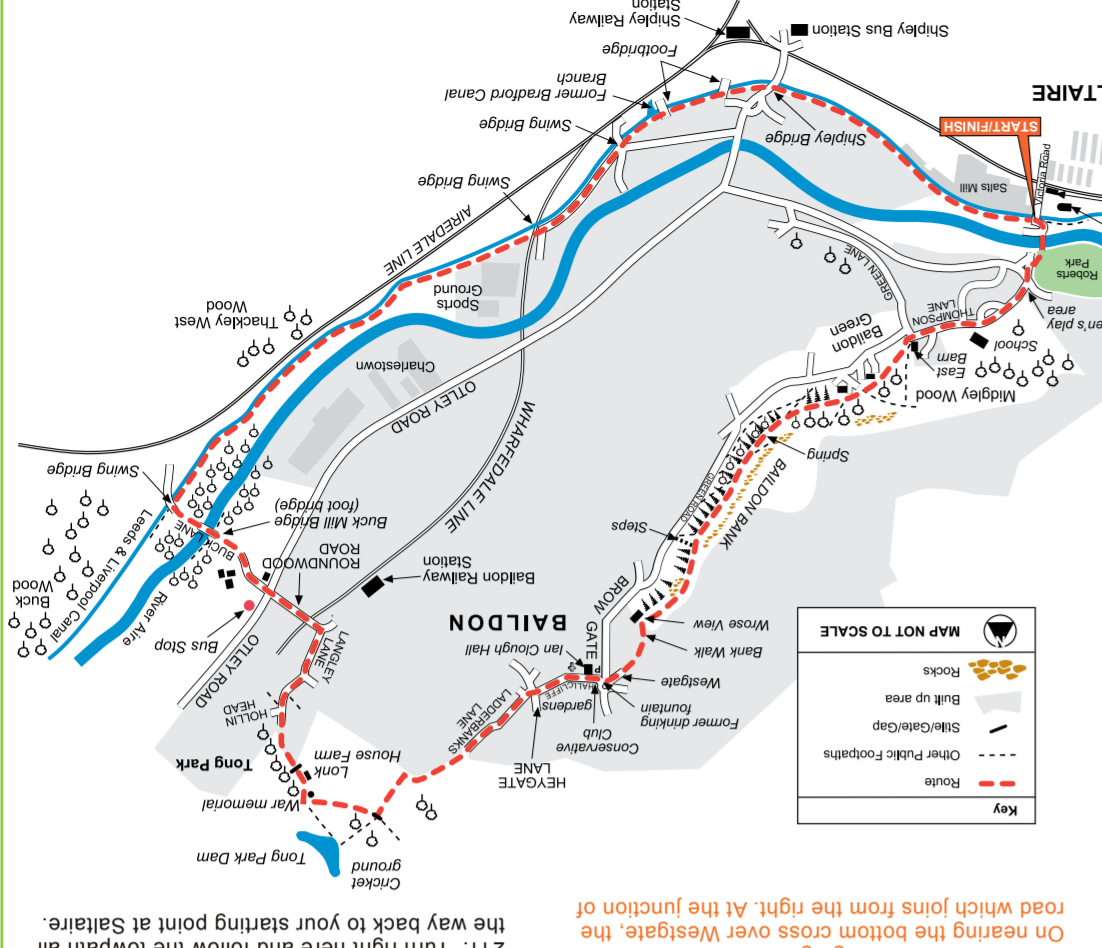

The Route

From the bottom of Victoria Road turn left down the narrow access road towards the car park. At the bottom of Victoria Road turn left down the road onto Thompson Lane opposite, walk along Thompson Lane passing on your left the children's play area and continue almost to the end of the lane, where, at the rear of the last house on the left East Barn, leave the pavement by turning left onto the rough, grassy area of Baildon Green.
 From here follow the well-defined path across wide path turn left uphill for a short distance before turning sharp right onto the well defined path runs from left to right. On reaching the gradual slope before joining to a much wider path the grass as it bears slightly to the right up a narrow gap in the perimeter wall out onto the path across the grass, to leave the park via the road onto Thompson Lane opposite, walk along Thompson Lane passing on your left the narrow access road towards the car park before leaving the surfaced path by turning right across the grass, to leave the park via the road onto Thompson Lane opposite, walk across Hegate Lane onto Ladderbanks Lane. Follow Ladderbanks Lane for quite a distance as narrow unsurfaced bridge before eventually reaching a gateway overlooking Tong Park Dam.
 At the top of the steps turn right along the surfaced path between the houses and the top edge of Westgate. Turn right down Westgate and walk along Bank Wrose View. Here turn left and walk along Bank Wrose View, bearing right at the end to join the narrow access road towards the car park. At the bottom of Victoria Road turn left down the road onto Thompson Lane opposite, walk along Thompson Lane passing on your left the children's play area and continue almost to the end of the lane, where, at the rear of the last house on the left East Barn, leave the pavement by turning left onto the rough, grassy area of Baildon Green.
 From here follow the well-defined path across wide path turn left uphill for a short distance before turning sharp right onto the well defined path runs from left to right. On reaching the gradual slope before joining to a much wider path the grass as it bears slightly to the right up a narrow gap in the perimeter wall out onto the path across the grass, to leave the park via the road onto Thompson Lane opposite, walk along Thompson Lane passing on your left the narrow access road towards the car park before leaving the surfaced path by turning right across the grass, to leave the park via the road onto Thompson Lane opposite, walk across Hegate Lane onto Ladderbanks Lane. Follow Ladderbanks Lane for quite a distance as narrow unsurfaced bridge before eventually reaching a gateway overlooking Tong Park Dam.
 At the top of the steps turn right along the surfaced path between the houses and the top edge of Westgate. Turn right down Westgate and walk along Bank Wrose View. Here turn left and walk along Bank Wrose View, bearing right at the end to join the narrow access road towards the car park.

Tong Park Dam

5 miles (8km) Circular Walk
2 1/4 miles (4.4km) Linear Walk

An ideal family walk with lots of interest and spectacular views. Suitable for most reasonably fit occasional walkers, through the mainly urban areas to the north east of the Bradford District. Although the towpath is accessible, wheelchairs and people with limited mobility. Comfortable strong footwear is recommended along with outdoor clothing to suit the season. A light snack or picnic is advisable, especially when walking with children.
 Please take care whilst walking along the canal towpath and river, especially with children - Be SAFE - Stay Away From the Edge.
 Walk start point: Bottom of Victoria Road, Saltaire Village

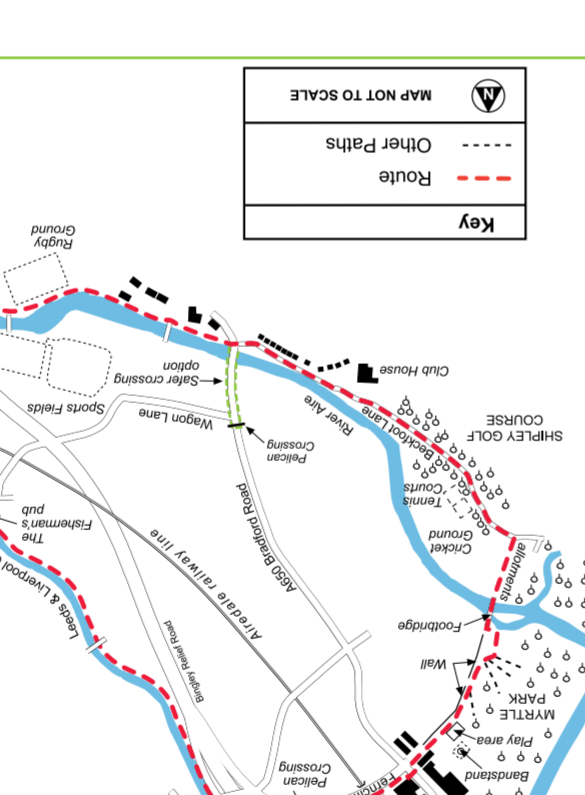

Water Woodland and Aire Valley

5 1/2 mile (8.8km) Circular Walk
2 1/2 mile (4km) Linear Walk

An ideal family walk with plenty of industrial heritage and natural history, as well as some close up views of the magnificent structures along the Bingley Relief Road. Although the towpath is accessible, wheelchairs and people who have walking difficulties.
 Comfortable strong walking shoes are recommended along with outdoor clothing to suit the season. A light snack/picnic is advisable especially when walking with children.
 Please take care whilst walking along the canal towpath and river, especially with children - Be SAFE - Stay Away From the Edge.
 Walk start point: The bottom of Victoria Road, Saltaire Village.

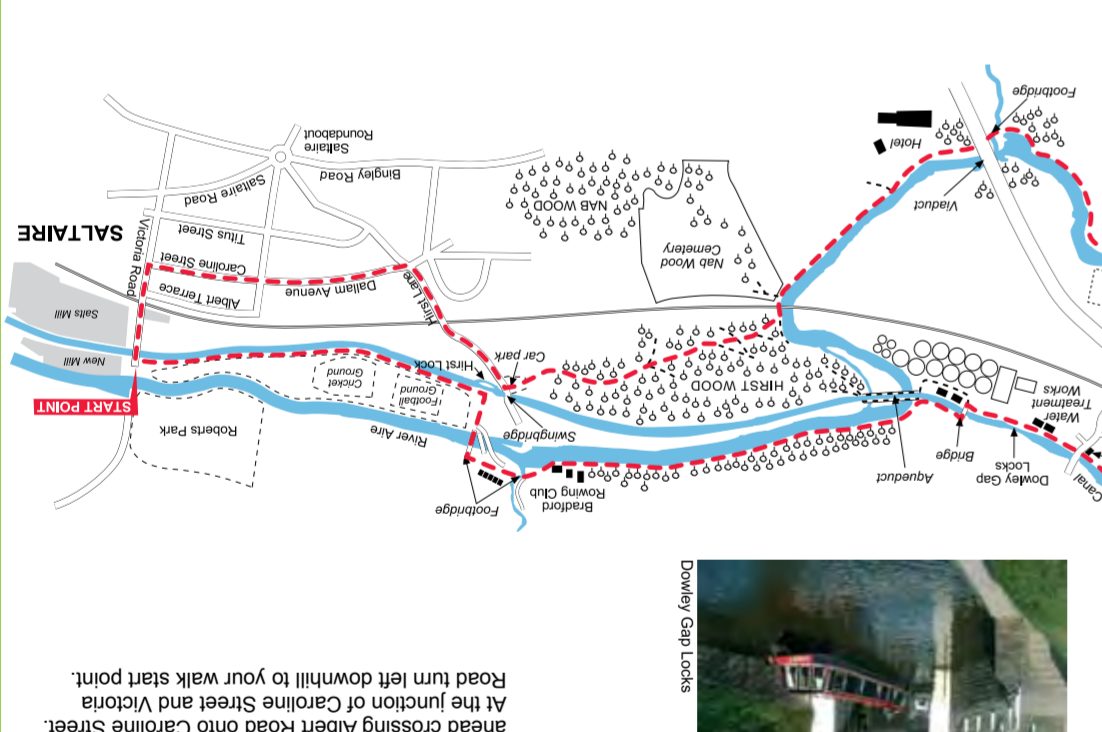

The Route

At the bottom of Victoria Road turn left down the access road and onto the canal towpath. Turn right along the towpath following it for approx. 1/2 mile to Hirst Lock. Here, halfway up the incline at the side of the lock turn right to go through a stile in the wall on your right. Ahead and over the metal footbridge spanning the River Aire, once across turn immediately left off the path to walk down the embankment and straight ahead across the grassy area, passing on the left two other bridge structures. Continue straight ahead and cross the small metal footbridge ahead onto a narrow dirt track adjacent to the weir.
 Here the footpath follows the riverbank bearing to the left to walk between the river and the side of a building and along in front of the Bradford Amateur Rowing Club. Continue straight ahead and cross the narrow mill dam.
 At the junction with the main Bradford Road, Saltaire, also Bingley stop at the top of Victoria Road, Saltaire. A direct rail service operates from nearby Bingley station to Saltaire station, near to where you started your walk.
 On reaching Bingley you can if you wish return to Saltaire station, near to where you started your walk. Cross over the main road and go through the gap in the wall of Cottingly Bridge opposite and down the steps onto the footpath along the canal towpath and up the steps onto a narrow, grassed area turn left off the wide path onto a narrow, surfaced path, which leads down to a metal bridge over the River Aire.
 Cross the river and along the straight narrow footpath to its junction with a country lane (Beckwith Lane). here turn left and follow the lane passing Bingley Golf Club on the left and Shipley Golf Club on the right. Continue straight ahead as the lane continues along the riverbank eventually passing the bottom of Nab Wood cemetery on your right, before going over a small footbridge and under the railway bridge to emerge into Hirst Wood. Here the path divides, our route follows the path steeply uphill to the right through the trees, where, on the crest of the hill join another path. Continue straight ahead through the woodland to emerge onto the car parking area at the bottom of Hirst Lane. Leave the car park turning right up Hirst Lane and over the railway bridge before turning left along the top of the children's play area walking along Daliam Avenue. Continue straight ahead crossing Albert Road onto Caroline Street. At the junction of Caroline Street and Victoria Road turn left downhill to your walk start point.